



Differential Assembly

Removal/Installation

⚠ WARNING

- Make sure jacks and safety stands are placed properly, and hoist brackets are attached to correct positions on the engine.
- Apply parking brake and block rear wheels, so car will not roll off stands and fall on you while working under it.

CAUTION: Use fender covers to avoid damaging painted surfaces.

1. Drain the engine coolant, (see [section 10](#))
2. Remove drain plug and drain differential oil (see page [15-4](#)).
3. Remove the driveshafts and intermediate shaft (see [section 16](#)).
4. Remove the lower plate.

NOTE: Reinstall the steering gearbox mounting bolts.

5. Remove the vehicle speed sensor (VSS)/power steering speed sensor.

NOTE: Do not disconnect the hoses.

6. Disconnect the oil cooler hoses at joint pipes.
7. Remove the secondary cover and 36 mm sealing bolt.

NOTE: Shift to 1st gear (M/T) or **P** position (A/T) to lock the secondary gear.

8. Disconnect the extension shaft from the differential using the special tool.
9. Remove the mounting bolts and 26 mm shim, then remove the differential assembly.

☆: Corrosion resistant bolt

☆STEERING GEARBOX MOUNTING BOLTS

10 x 1.25 mm
60 N·m (6.0 kg-m, 44 lb-ft)

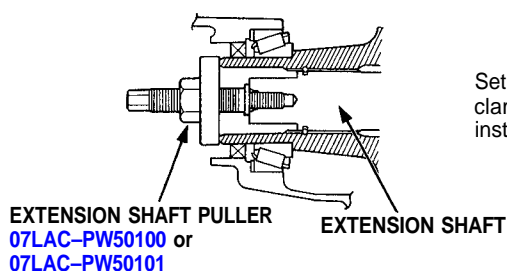
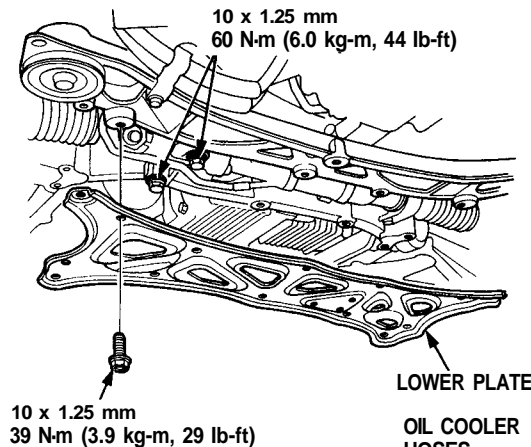
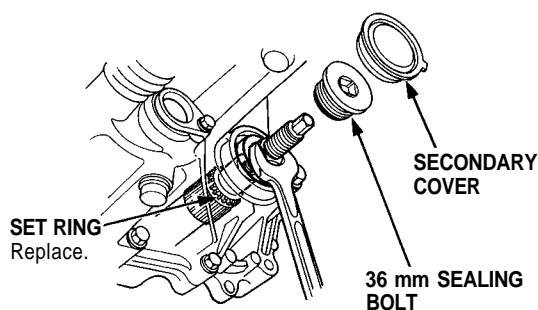

Set this bolt and breather hose clamp into the bolt hole before installing the differential assembly.

12 x 1.25 mm
65 N·m (6.5 kg-m, 47 lb-ft)

Replace.

DIFFERENTIAL ASSEMBLY

12 x 1.25 mm
65 N·m (6.5 kg-m, 47 lb-ft)

26 mm SHIM

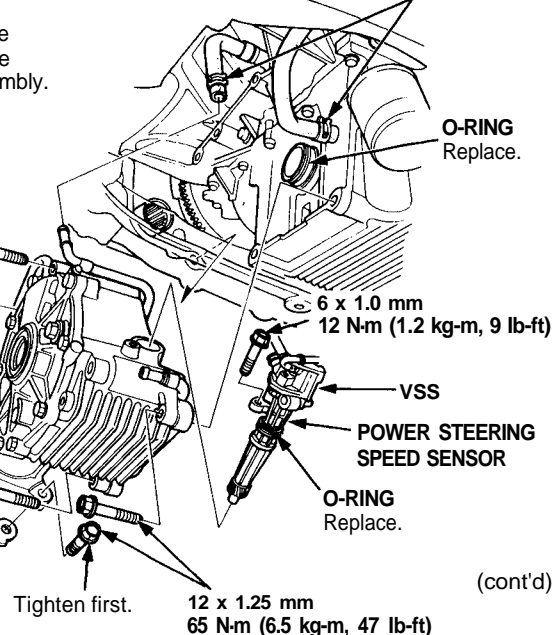

(cont'd)

Differential Assembly

Removal/Installation (cont'd)

10. Install the differential assembly in the reverse order of removal, and as follows.

● EXTENSION SHAFT, 36 mm SEALING BOLT

- 1. Apply Super High Temp Urea Grease (P/N 08798 — 9002) to the splines of the extension shaft, then install the new set ring.

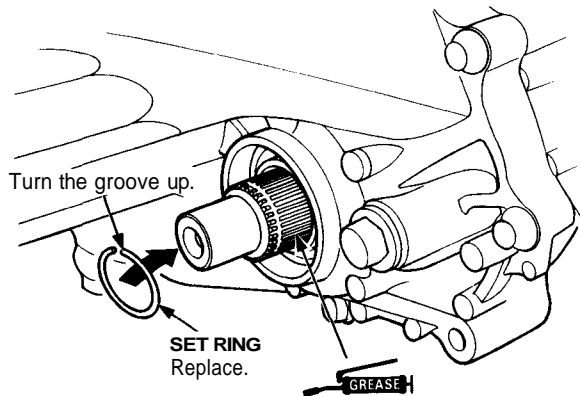

- 2. Install the extension shaft using the special tool as shown.

NOTE: Make sure extension locks in the secondary gear.

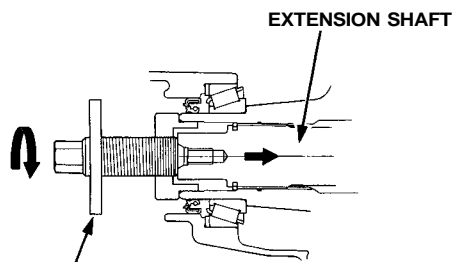

EXTENSION SHAFT INSTALLER
07MAF-PY40100 or 07MAF-PY40101

- 3. Fill the secondary gear with Super High Temp Urea Grease (P/N 08798 — 9002)

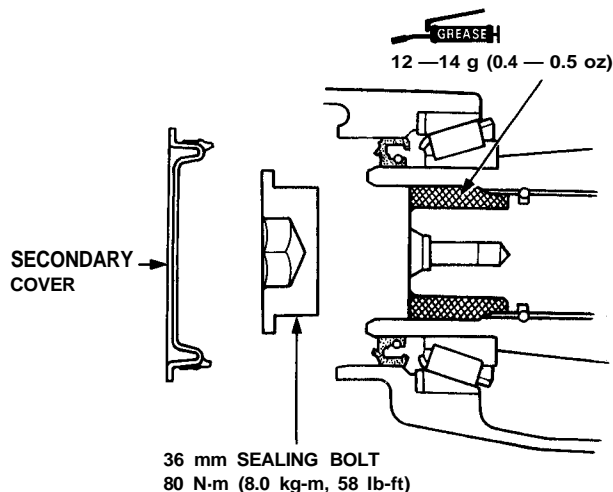

- 4. Install the 36 mm sealing bolt and secondary cover.

NOTE: Apply liquid gasket (P/N 08718 — 0001) to the 36 mm sealing bolt threads.

● ADJUSTING THE 26 mm SHIM

- 1. Install the differential assembly.
- 2. Measure the clearance between the differential case and clutch housing (M/T) or torque converter housing (A/T).

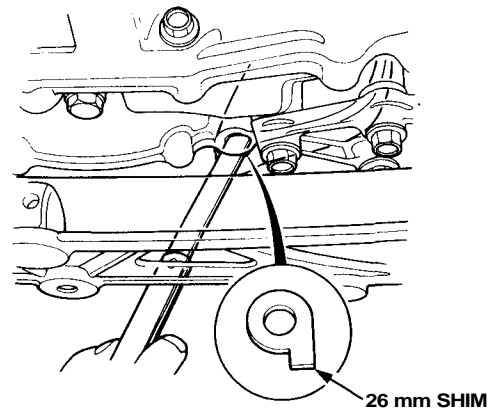

- 3. Select shim from the following table.

26 mm SHIM

Part Number	Thickness	Measurement Value
41432 — PY4 — 000	1.9 mm (0.0748 in)	1.99 — 1.9 mm
41433 — PY4 — 000	2.0 mm (0.0787 in)	2.09 — 2.0 mm
41434 — PY4 — 000	2.1 mm (0.0827 in)	2.19 — 2.1 mm
41435 — PY4 — 000	2.2 mm (0.0866 in)	2.29 — 2.2 mm
41436 — PY4 — 000	2.3 mm (0.0906 in)	2.39 — 2.3 mm
41437 — PY4 — 000	2.4 mm (0.0945 in)	2.49 — 2.4 mm
41438 — PY4 — 000	2.5 mm (0.0984 in)	2.59 — 2.5 mm
41439 — PY4 — 000	2.6 mm (0.1024 in)	2.69 — 2.6 mm
41440 — PY4 — 000	2.7 mm (0.1063 in)	2.79 — 2.7 mm
41441 — PY4 — 000	2.8 mm (0.1102 in)	2.89 — 2.8 mm
41442 — PY4 — 000	2.9 mm (0.1142 in)	2.99 — 2.9 mm
41443 — PY4 — 000	3.0 mm (0.1181 in)	3.09 — 3.0 mm

11. Check the following items after reassembly.

- 1. Differential has been refilled.
- 2. Engine coolant has been refilled.
- 3. The clip at the tip of the driveshafts is completely inserted into the groove of the differential or intermediate shaft.